

BO4111

REMOVAL

HINT:

A bolt without a torque specification is shown in the standard bolt chart (see page [SS-2](#)).

1. DISCONNECT CABLE FROM NEGATIVE BATTERY TERMINAL

Disconnect the cable from the negative (-) battery terminal.

NOTICE:

If the cable is disconnected from the negative battery terminal, the preset AM and FM stations stored in the memory will be erased. Be sure to make note of them before disconnecting the cable.

CAUTION:

Work must not be started until at least 90 seconds after the ignition switch is turned to the LOCK position and the cable is disconnected from the negative (-) battery terminal.

(The SRS is equipped with a back-up power source. If work is started within 90 seconds of disconnecting the cable from the negative (-) battery terminal, the SRS may deploy.)

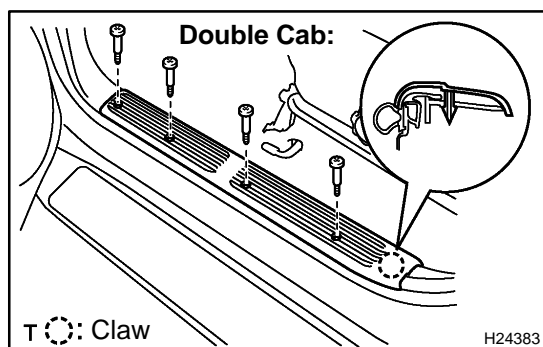

2. REMOVE FRONT DOOR SCUFF PLATE

- (a) Standard cab:
Remove the 5 screws and front door scuff plate.
- (b) Access cab (standard and wide body type):
Remove the 4 screws and front door scuff plate.
- (c) Double cab:
Remove the 4 screws and front door scuff plate.
- (d) Use the same procedures described above on the other side.

3. Standard cab:

Access cab:

REMOVE COWL SIDE TRIM

- (a) Remove the 2 clips and cowl side trim.
- (b) Use the same procedures described above on the other side.

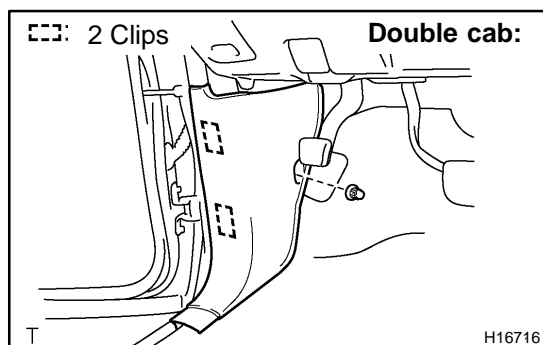

4. Double cab:

REMOVE COWL SIDE TRIM BOARD

- (a) Remove the nut, 2 clips and cowl side trim board.
- (b) Use the same procedures described above on the other side.

5. Double cab:

REMOVE SIDE PANEL

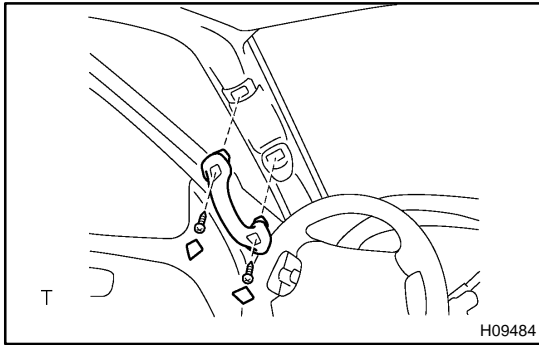

6. REMOVE ASSIST GRIPS

- (a) Using a screwdriver, remove the plugs.

HINT:

Tape the screwdriver tip before use.

- (b) Driver side:

Using a torx® driver, remove the 2 torx® screws and assist grip.

Torx® driver:

T30 (Part No.09041-00030 or locally manufactured tool)

- (c) Standard cab (Passenger side):

Access cab (Passenger side):

Using a torx® driver, remove the 4 torx® screws and 2 assist grips.

Torx® driver: T30 (Part No.09041-00030 or locally manufactured tool)

- (d) Double cab (Passenger side):

Using a torx® driver, remove the 2 torx® screws and assist grips.

Torx® driver:

T30 (Part No.09041-00030 or locally manufactured tool)

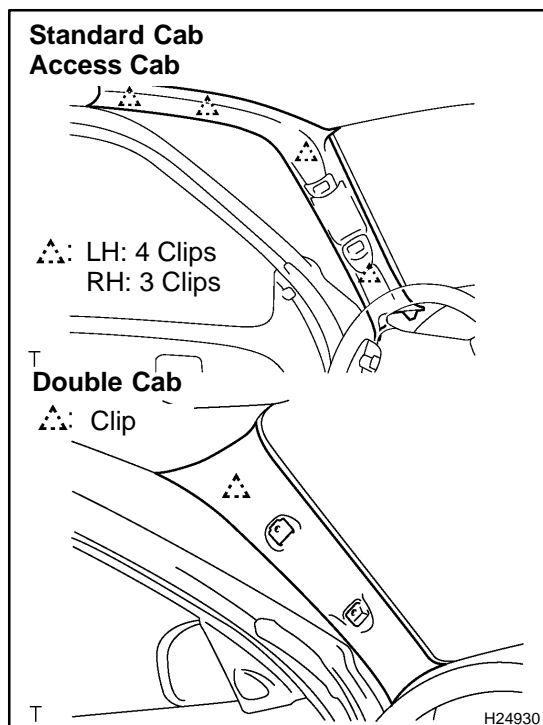

7. REMOVE FRONT PILLAR GARNISH

- (a) Using a screwdriver, remove the front pillar garnish.

HINT:

Tape the screwdriver tip before use.

- (b) Use the same procedures described above on the other side.

8. REMOVE STEERING WHEEL PAD

(See page [SR-18](#), [SR-33](#))

9. REMOVE STEERING WHEEL

(See page [SR-18](#), [SR-33](#))

10. REMOVE STEERING COLUMN COVERS

(See page [SR-18](#), [SR-33](#))

11. REMOVE COMBINATION SWITCH

Disconnect the 4 connectors and remove the 3 screws and combination switch.

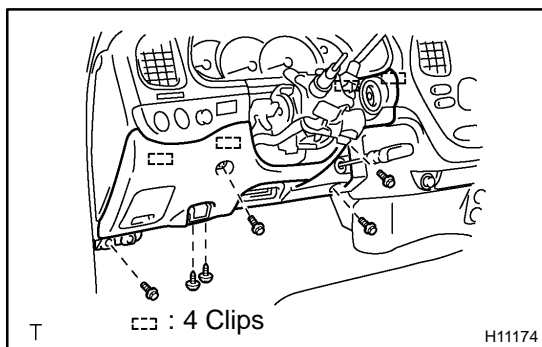
**12. REMOVE LOWER FINISH PANEL**

- (a) Remove the 2 screws and hood lock release lever.
- (b) Remove the 4 bolts and lower finish panel.
- (c) Disconnect the connectors.

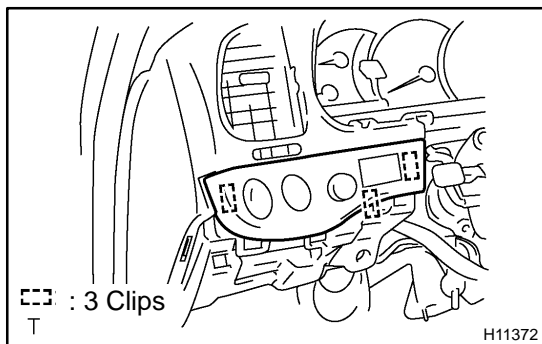
**13. REMOVE SWITCH BASE**

Using a screwdriver, lift up the switch base and remove it.

HINT:

Tape the screwdriver tip before use.

14. REMOVE NO. 2 HEATER TO REGISTER DUCT**15. REMOVE STEERING COLUMN**

(See page [SR-18](#), [SR-33](#))

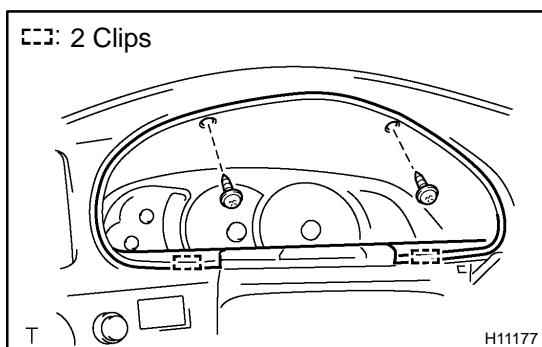
**16. REMOVE CLUSTER FINISH PANEL**

Remove the 2 screws and cluster finish panel.

17. REMOVE COMBINATION METER

- (a) Remove the 4 screws.
- (b) Remove the combination meter and disconnect the 4 connectors.

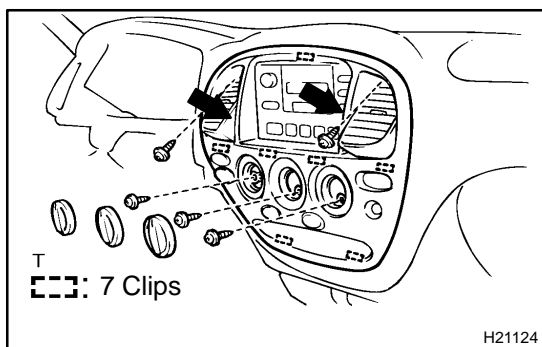
**18. REMOVE INTEGRATION CONTROL PANEL**

- (a) Remove the 3 control knobs.
- (b) Remove the 5 screws.
- (c) Remove the integration control panel by pulling at the positions indicated by the arrows in the illustration.
- (d) Disconnect the connectors.

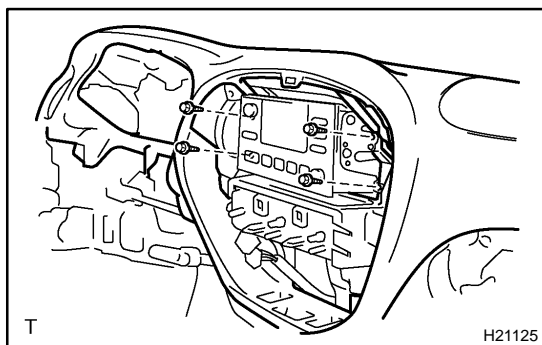
**19. REMOVE RADIO TUNER ASSEMBLY**

- (a) Disconnect the connector.
- (b) Remove the 4 bolts and the radio tuner assembly.

20. REMOVE HEATER CONTROL ASSEMBLY

(See page [AC-101](#))

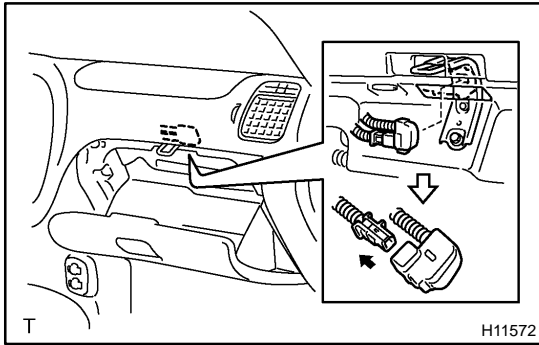

21. DISCONNECT PASSENGER AIRBAG ASSEMBLY CONNECTOR

NOTICE:

When handling the airbag connector, take care not to damage the airbag wire harness.

- Using a clip remover, disengage the connector clamp.
- Disconnect the connector as shown in the illustration.

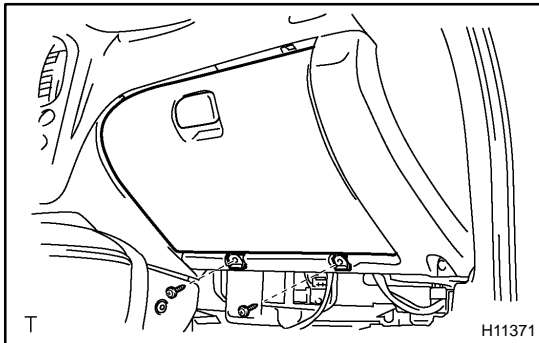

22. REMOVE GLOVE COMPARTMENT DOOR

Remove the 2 screws and glove compartment door.

23. REMOVE LOWER NO. 2 FINISH PANEL

Remove the 3 screws and lower No. 2 finish panel.

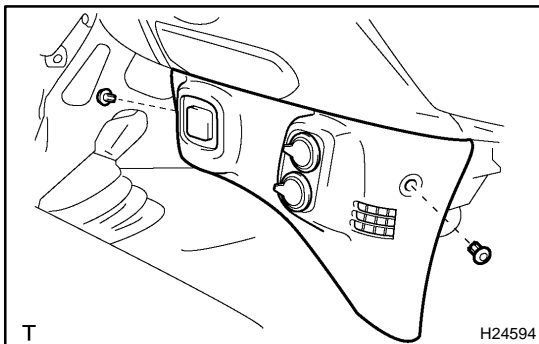

24. Standard cab:

Access cab (w/o Large type console box):

Double cab (Split type seat):

REMOVE LOWER CENTER COVER

- Remove the 2 clips and lower center cover.
- Disconnect the connectors.

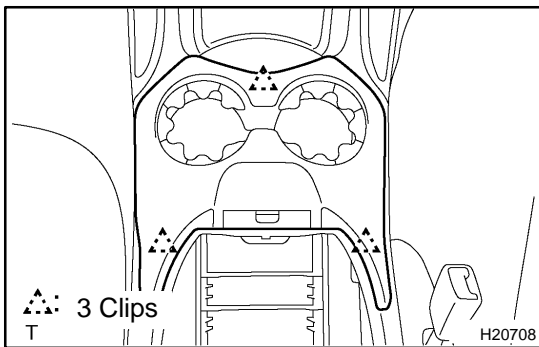

25. Access cab (w/ Large type console box):

REMOVE FRONT CONSOLE BOX ASSEMBLY

- Remove the shifting hole cover.
- Using a screwdriver, disengage the 3 clips and remove the console panel upper.

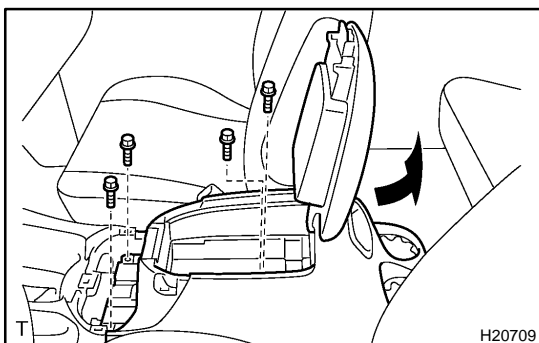

- Remove the 4 bolts and console rear end panel No. 2.

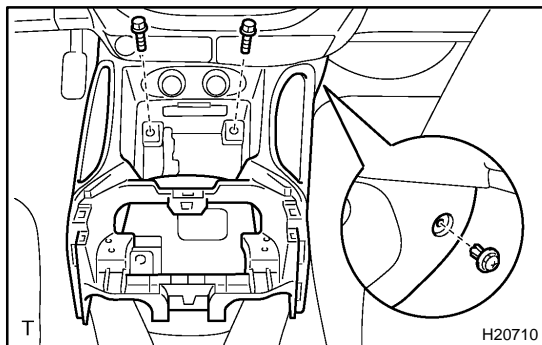

- (d) Remove the 2 bolts, clip and the front console box assembly.
- (e) Disconnect the connector.

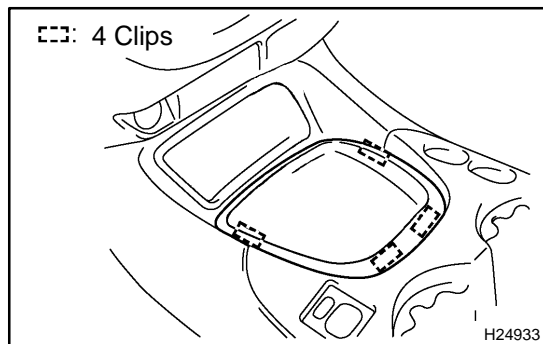

26. Double cab:
REMOVE SHIFTING HOLE COVER

- (a) Using a screwdriver, disengage the 4 clips and remove the shifting hole cover.

HINT:

Tape the screwdriver tip before use.

27. Double cab:
REMOVE UPPER CONSOLE PANEL

- (a) w/ Seat heater:
Using a screwdriver, remove the seat heater switches, then disconnect the connectors.

HINT:

Tape the screwdriver tip before use.

- (b) Using a screwdriver, remove the power mirror control switch, then disconnect the connector.

HINT:

Tape the screwdriver tip before use.

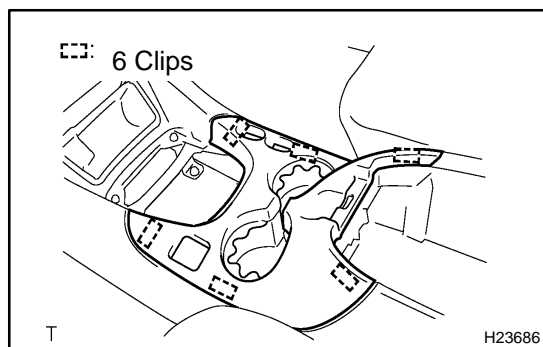

- (c) Using a screwdriver, disengage the 6 clips and remove the upper console panel.

HINT:

Tape the screwdriver tip before use.

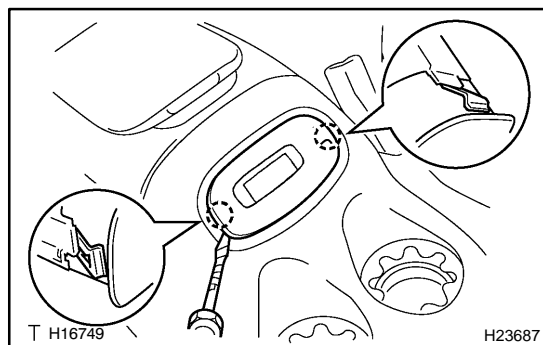

28. Double cab:
REMOVE REAR CONSOLE BOX

- (a) w/ VTR control garnish.
Using a screwdriver, disengage the 2 claws, and remove the VTR control garnish and connector.

- (b) Disconnect the connector.

HINT:

Tape the screwdriver tip before use.

- (c) w/o VTR control garnish.

Using a screwdriver, remove the rear console pocket.

HINT:

Tape the screwdriver tip before use.

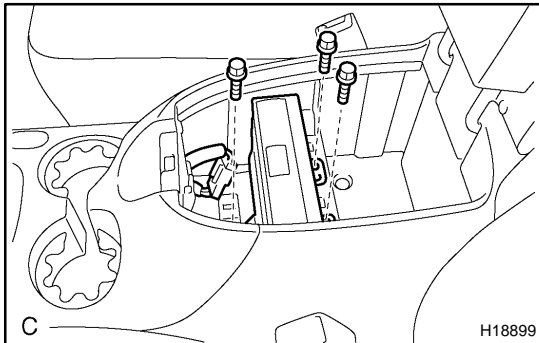

- (d) w/ Rear seat entertainment:
- (1) Remove the disc bracket.
 - (2) Remove the 3 bolts and disc player.
 - (3) Disconnect the connector.
- (e) Remove the 4 bolts and rear console box.

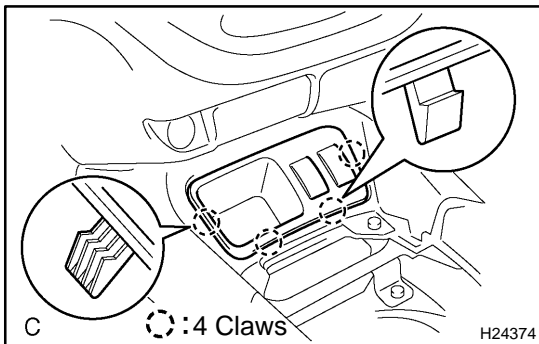

29. Double cab:

REMOVE CONSOLE BOX POCKET

- (a) Using a screwdriver, disengage the 4 claws.

HINT:

Tape the screwdriver tip before use.

- (b) Disconnect the connectors and remove the console box pocket.

30. REMOVE FRONT CONSOLE BOX

Remove the 2 bolts, 2 clips and front console box.

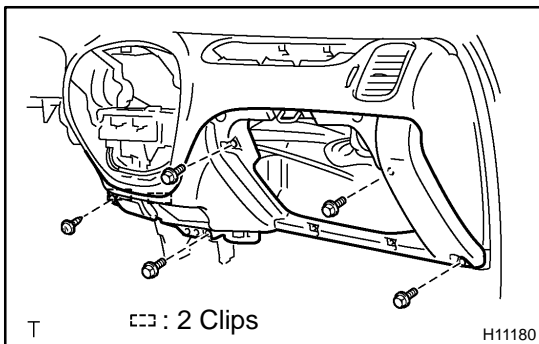

31. REMOVE LOWER INSTRUMENT COVER

- (a) Remove the 4 bolts and screw.
- (b) Using a screwdriver, disengage the clips and remove the lower instrument cover.

HINT:

Tape the screwdriver tip before use.

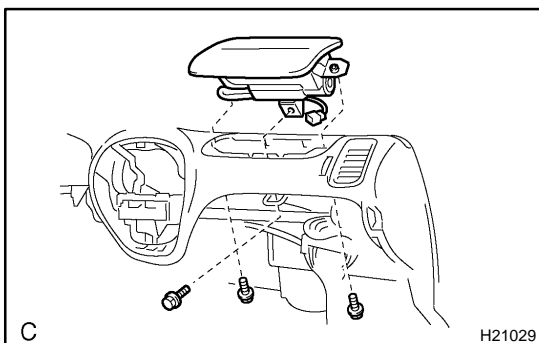

32. REMOVE PASSENGER AIRBAG ASSEMBLY

- (a) Remove the 2 bolts which hold the passenger airbag assembly and instrument panel.

Torque: 5.0 N·m (51 kgf-cm, 44 in.-lbf)

- (b) Remove the bolt which hold the passenger airbag assembly and instrument panel reinforcement.

Torque: 20 N·m (204 kgf-cm, 15 ft-lbf)

CAUTION:

- Do not place the passenger airbag assembly with the airbag deployment side facing down.

- **Never disassemble the passenger airbag assembly.**

33. w/ Rear console box:**REMOVE REAR CONSOLE BOX**

- (a) Using a screwdriver, remove the console box pocket.

HINT:

Tape the screwdriver tip before use.

- (b) Remove the 4 bolts and rear console box.

34. REMOVE NO. 4 HEATER TO REGISTER DUCT**35. REMOVE INSTRUMENT PANEL**

- (a) Remove the nut.
- (b) Disconnect the connectors and remove the instrument panel.

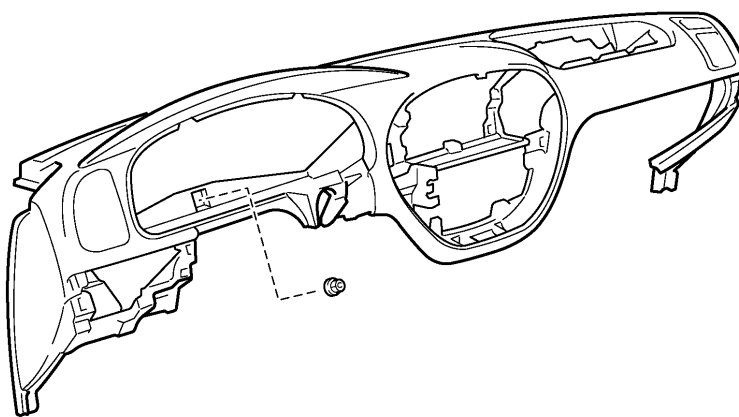

T

H11181

36. REMOVE CENTER HEATER TO REGISTER DUCT**37. REMOVE INSTRUMENT PANEL REINFORCEMENT**

- (a) Disconnect the connectors.
- (b) Remove the bolt and door control receiver.
- (c) Remove the 3 bolts, nut and No. 1 brace.
- (d) Remove the bolt, nut and No. 2 brace.
- (e) Remove the 3 bolts, 4 nuts and instrument panel reinforcement.

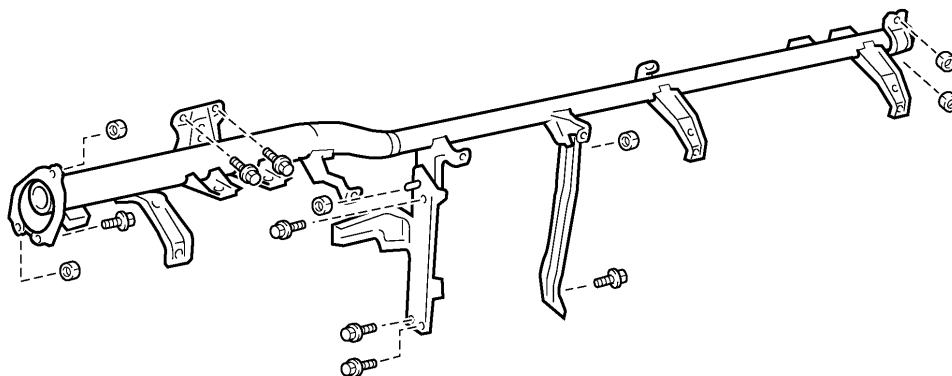

T

H11182